

INCLUDED IN KIT:

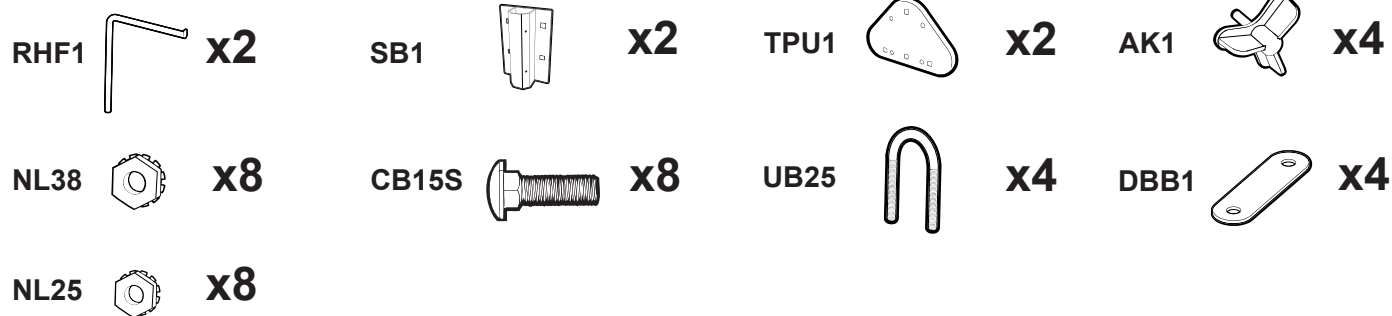

TOOLS REQUIRED:

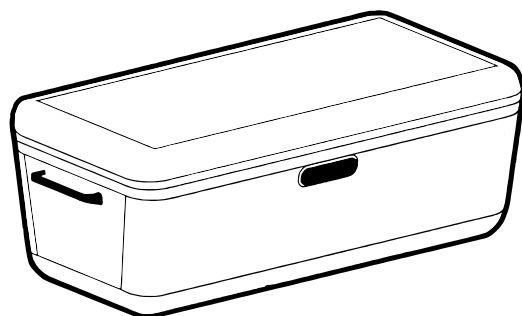
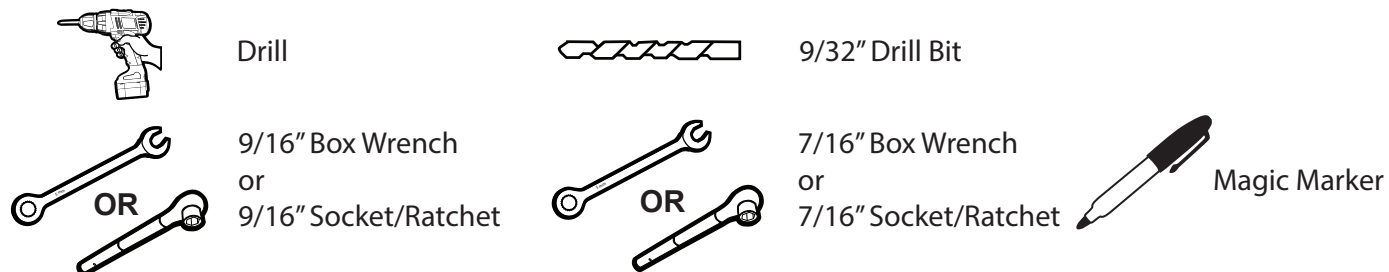

NOT INCLUDED WITH KIT

PLEASE NOTE: THE STORAGE BOX HOLDER KIT DOES NOT INCLUDE A DOCK BOX AND ONLY THE HARDWARE TO INSTALL A BOX TO THE DOCK. THE DOCK BOX WILL BE SUPPLIED BY THE CUSTOMER.

1

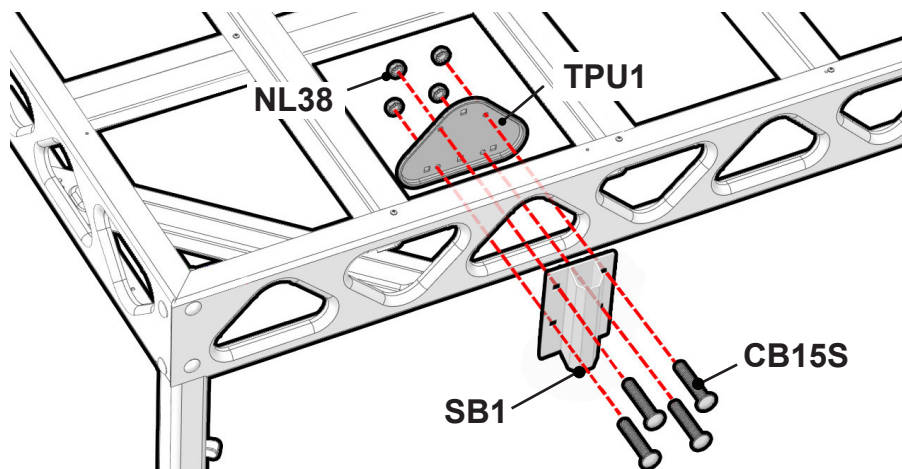

It is recommended to find an opening for the dock box hardware on the dock that does not interfere with other dock accessories.

PLEASE NOTE: The decking has been removed from the above image to better illustrate installation.

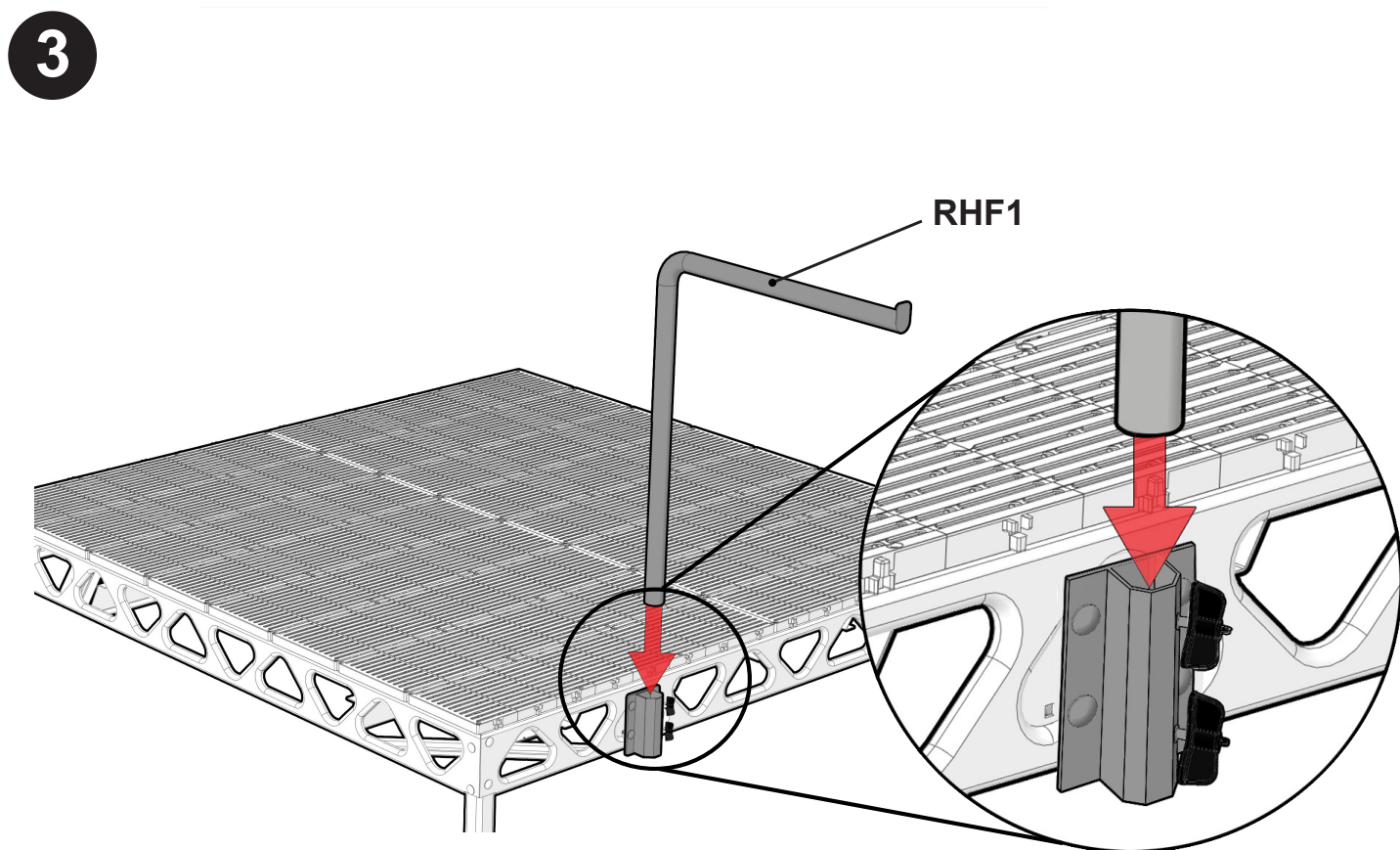
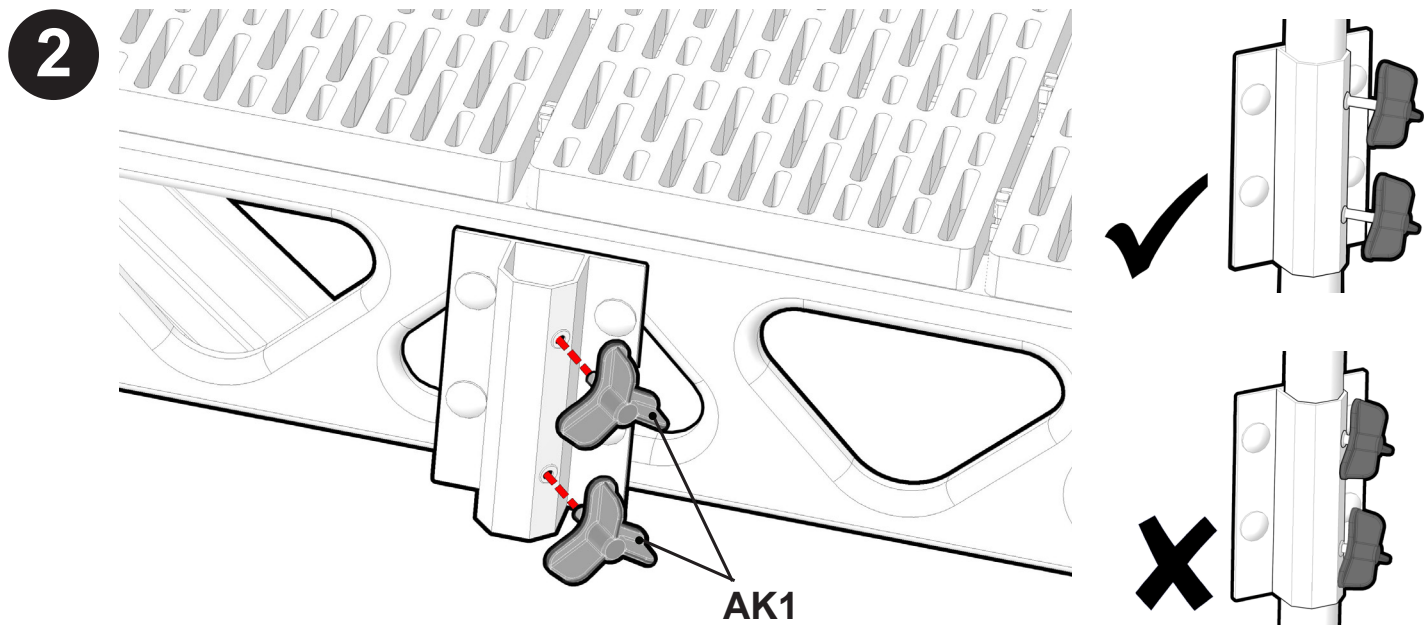

The height of your dock box may be adjusted by sliding the rack frame(RHF1) up or down to the height you require and tightening the adjustment knobs(AK1).

4

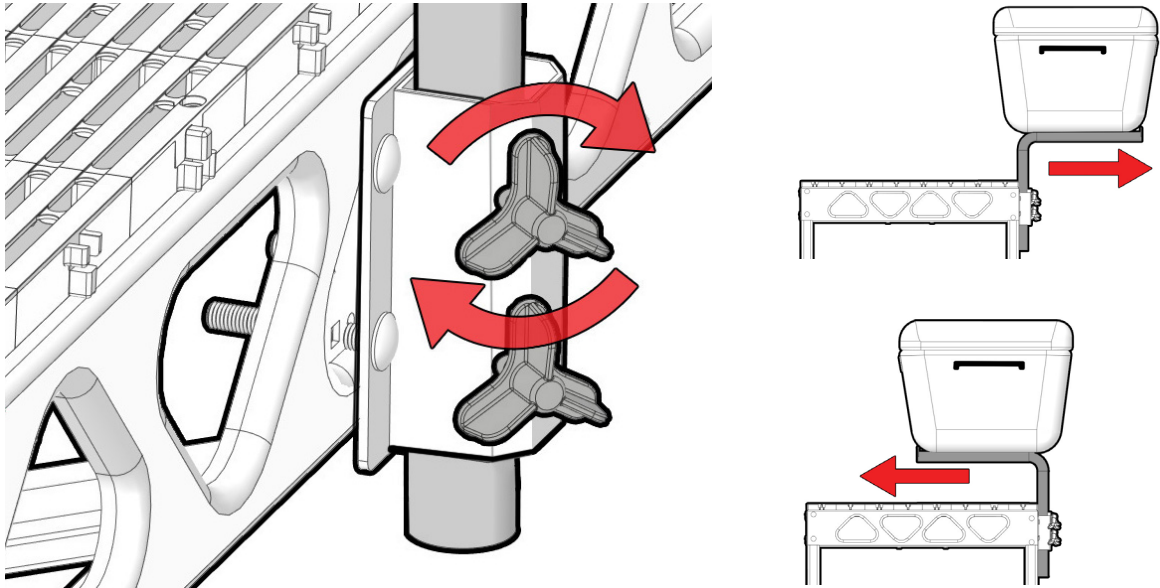

After you have adjusted the height of the rack frame(RHF1) to the desired height for your dock box tighten the adjustment knobs(AK1).

PLEASE NOTE: Depending on your preference the rack frames(RHF1) can be placed facing towards or away from the dock.

5

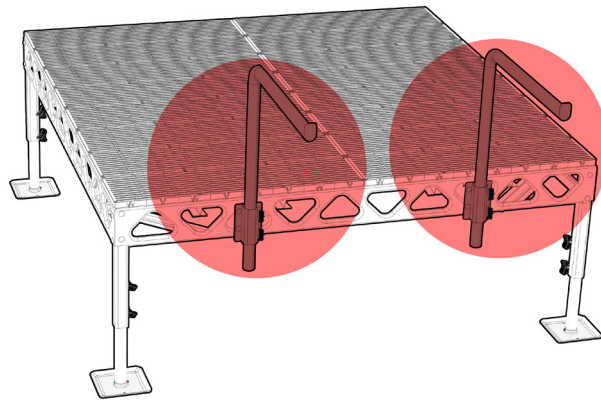

Repeat Steps 1-4 for second rack frame/bracket set.

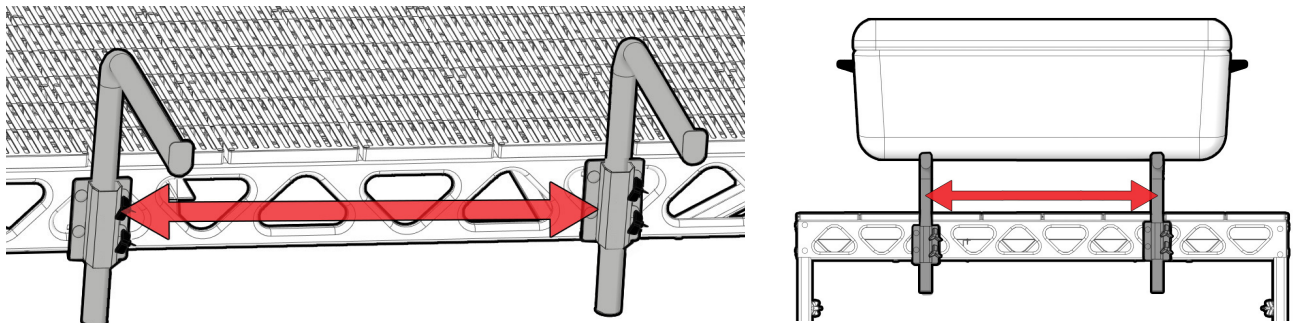

Spread brackets the appropriate amounts of spaces apart to accommodate the bottom of your dock box.

6

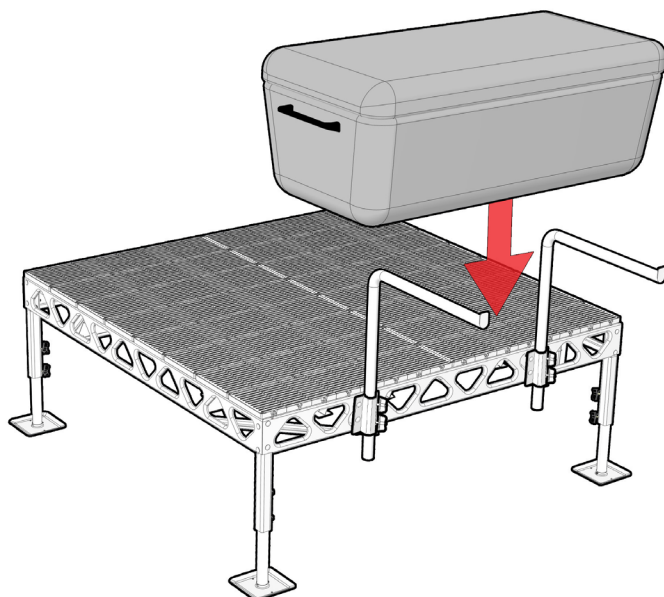

PLEASE NOTE: Dock box is supplied by customer.

7

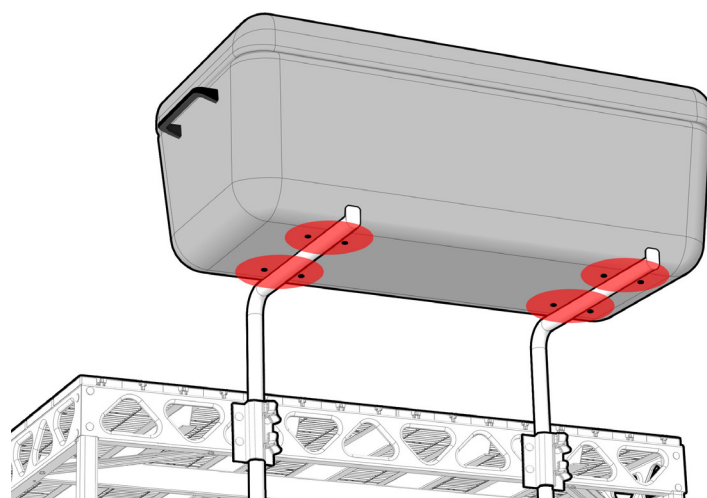
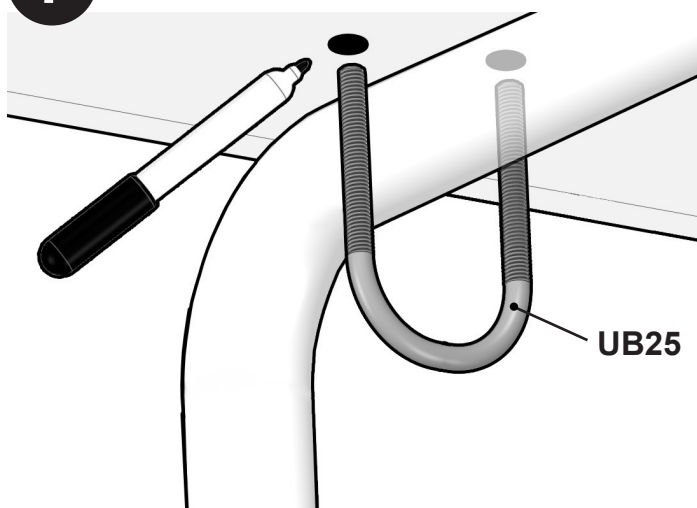

Approximate the position for all 4 U-Bolts(UB25) and mark holes for drilling.

8

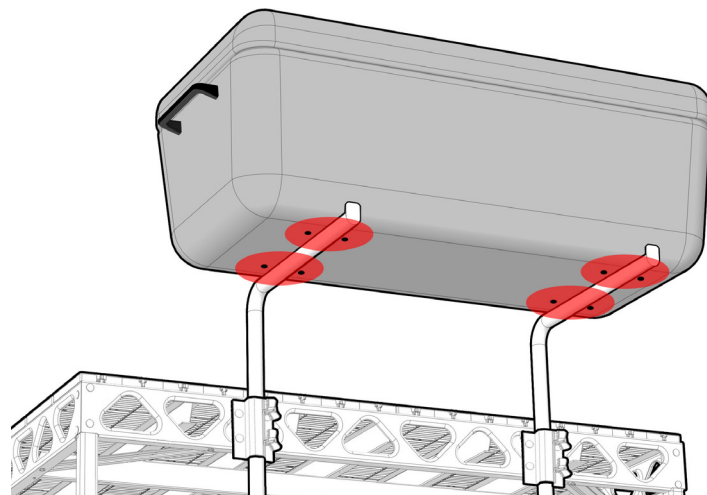
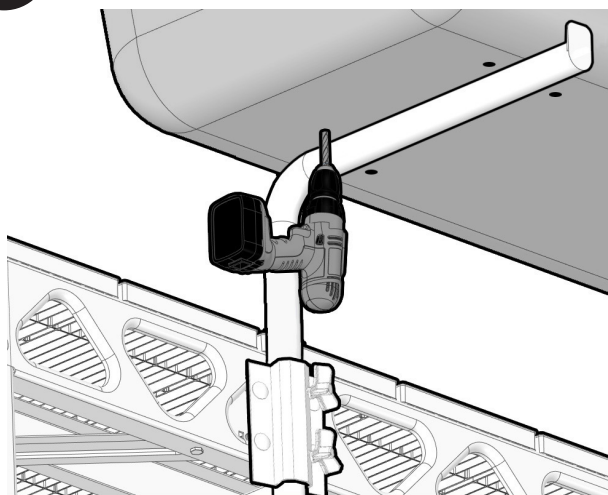

9

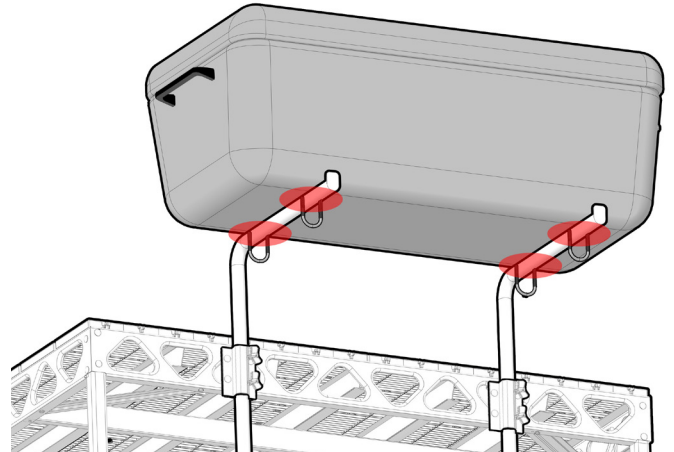
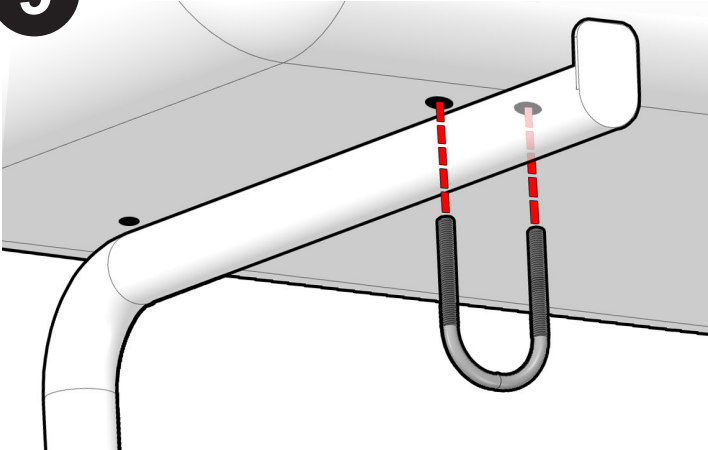

10

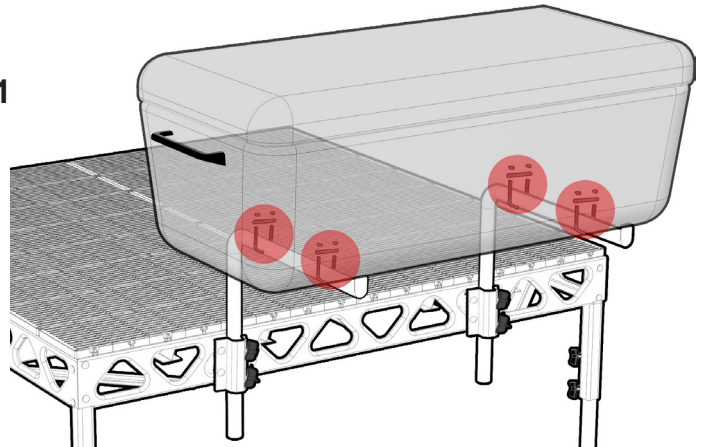
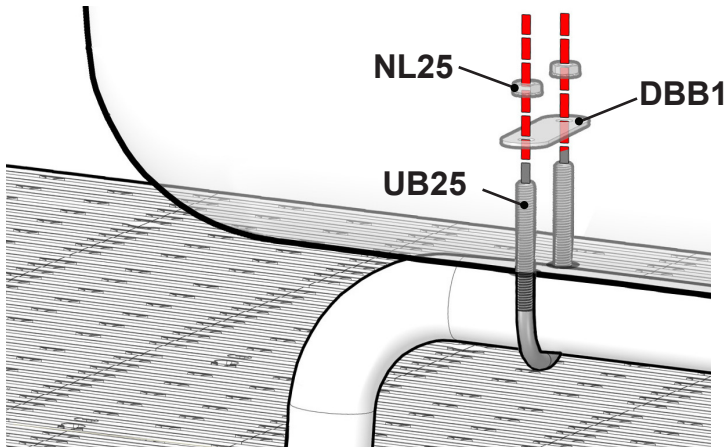

Connect all 4 U-Bolts(UB25) and necessary hardware from the inside of the dock box.

