

### INCLUDED IN KIT:

DWSB1



X2

DWSB2

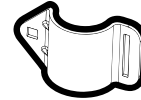

X2

DWBR63  
or  
DWBR120



X2

NL38



X4  
X8 \*

CB15S

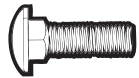

X2  
X4 \*

\*

The kit contains additional carriage bolts and nuts for any chain retainers that are added to your dock system.

### TOOLS REQUIRED:

9/16" Wrench  
or  
9/16" Socket with Ratchet

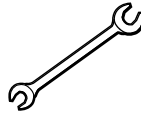

OR

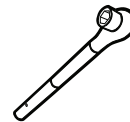

### KIT TYPES:

**PLEASE NOTE:** 4X8 docks require the 63" inch brace and 8x8 docks require the 120" inch brace.

**4x8 DOCK**

63" Kit

(DWBR63)\*

**8x8 DOCK**

120"(10FT) Kit

(DWBR120)\*

1

Start at **Step 2** for deep water braces without the addition of chain retainers.

Start at **Step 3** for deep water braces used with chain retainers.

# DEEP WATER LEG BRACE INSTRUCTIONS 4X8 DOCK / 8x8 DOCK

## 2 Instructions (for use without the addition of chain retainers)

DWBR63  
or  
DWBR120



X1

NL38



X1

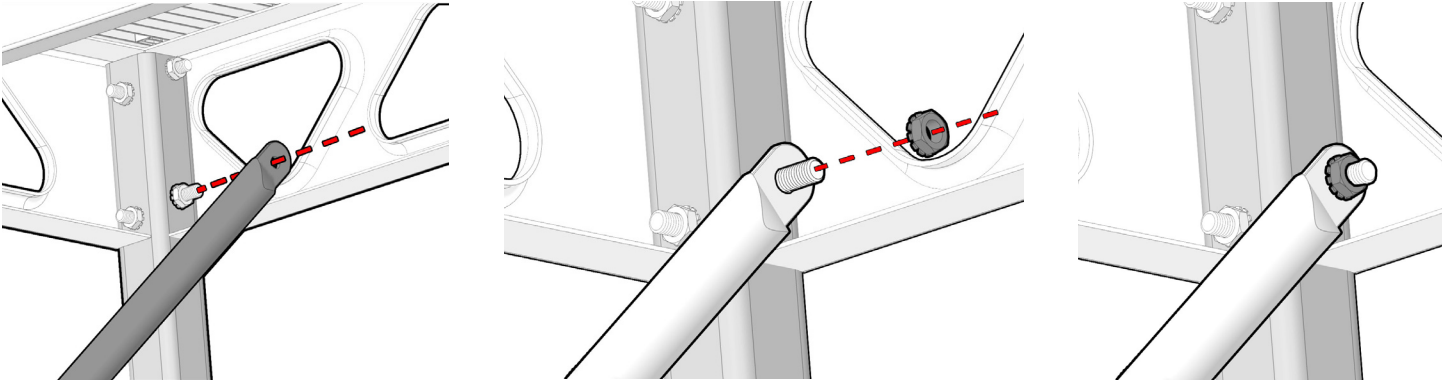

Install brace to the inside of the dock leg (See image above). Place overtop of the existing locknut and fasten with a new lock nut (NL38). Follow **Step 2** for any additional braces.

**PLEASE NOTE:** Only hand tighten locknuts so the brace may move freely for **Step 5**. If you are adding retainers to your dock continue to **Step 3**, if you are not, continue to **Step 4**.

## 3 Instructions (for use with the addition of chain retainer) Continued next page

NL38



X3

CB15S

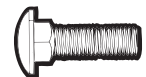

X1

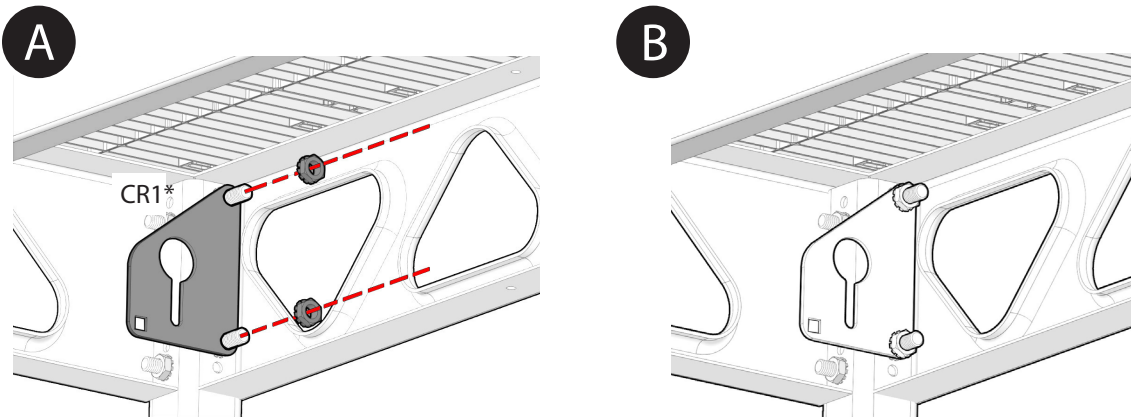

Place chain retainer overtop of the existing lock nuts and fasten with a new locknut (NL38) on top and bottom (See image above). Tighten locknuts.

Chain retainer complete.

\* Chain Retainer (CR1) is sold separately

# DEEP WATER LEG BRACE INSTRUCTIONS 4X8 DOCK / 8x8 DOCK

Continued from last page

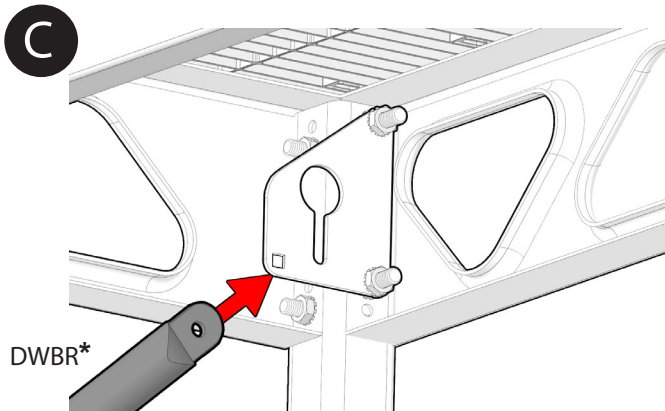

Place top hole of brace onto the hole of the chain retainer (See image above).

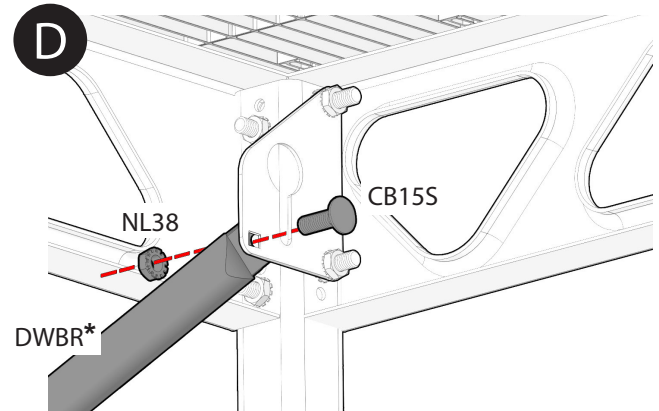

Fasten brace with carriage bolt and locknut.  
**PLEASE NOTE:** Only hand tighten the nuts so the brace moves freely for **Step 5**.

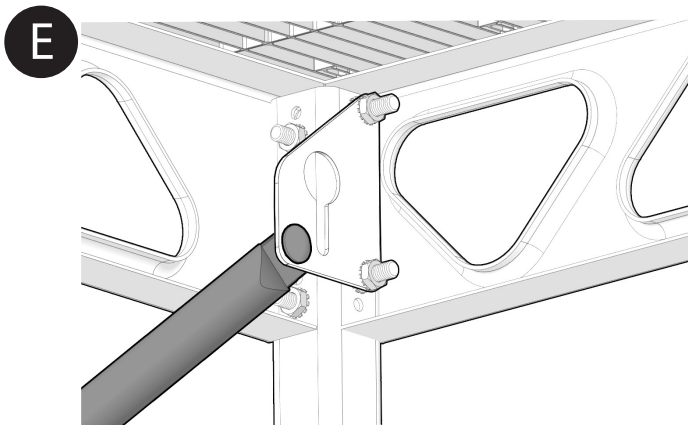

Brace top complete. Repeat **Steps 3 A-E** for any additional braces and continue to **Step 4**.

\* If you purchased the 4x8 dock kit the **DWBR63** brace will be used. If you purchased the 8x8 dock kit the **DWBR120** brace will be used.

## 4

DWSB1 X1  
DWSB2 X1

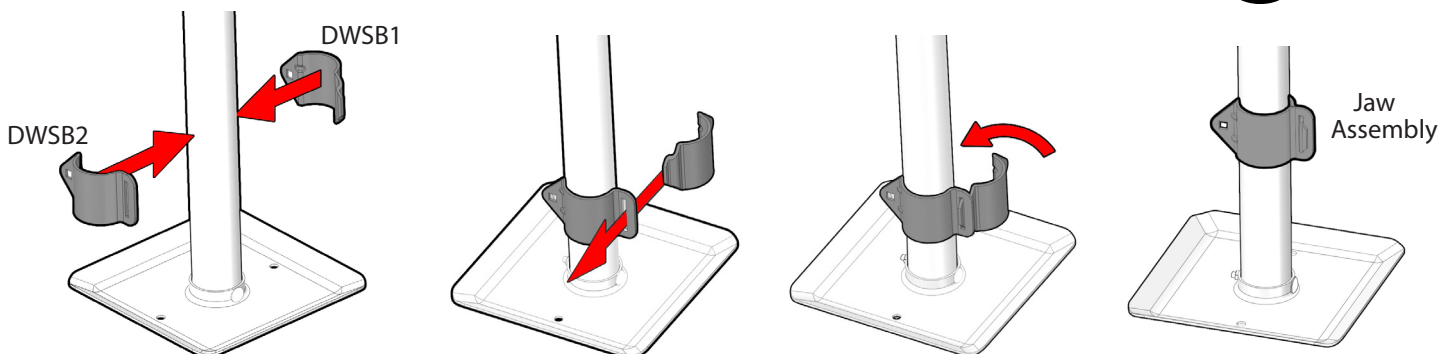

Fasten both jaws (DWSB1 & DWSB2) together on the leg. Repeat **Step 3** for other legs that any installed braces will be connected to.

5

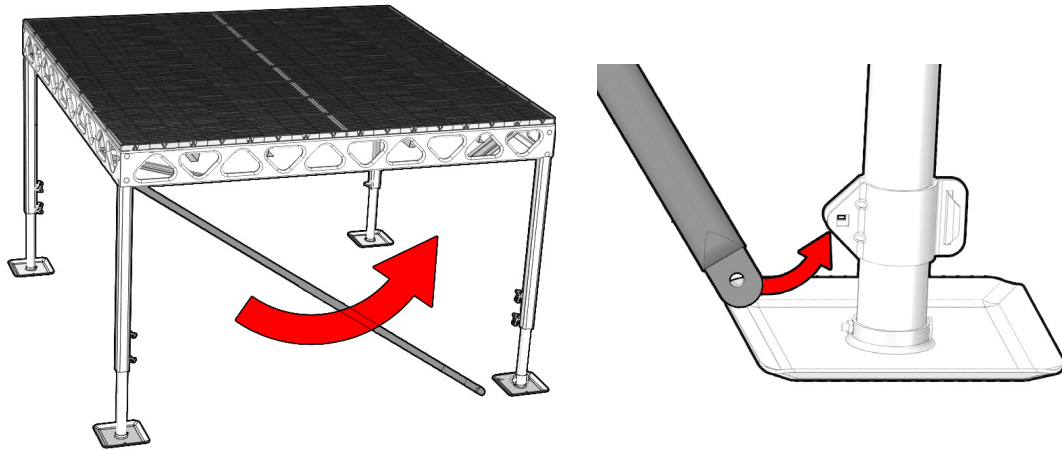

With the brace connected at one end place the opposite end between the two slots located on the edge of the jaw assembly (See image above).

6

NL38



X1

CB15S

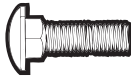

X1

7

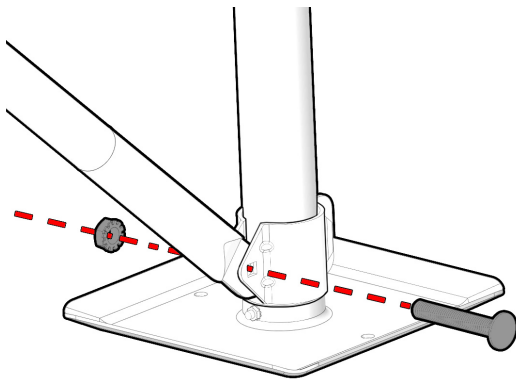

Braces complete.

Fasten the brace end with a carriage bolt (CB15S) and locknut (NL38). Tighten both ends of the brace. Repeat Steps from the beginning of the instruction to connect the second brace to the dock.