

INCLUDED IN KIT:

SB1



x1

CB35S



x4

NL38



x4

TPU1



x1

AK1



x2

FPP01



x1

TOOLS REQUIRED:

9/16" SOCKET WITH RATCHET TO SUIT
OR
9/16" BOX WRENCH

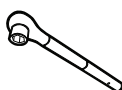

OR

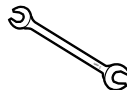

1

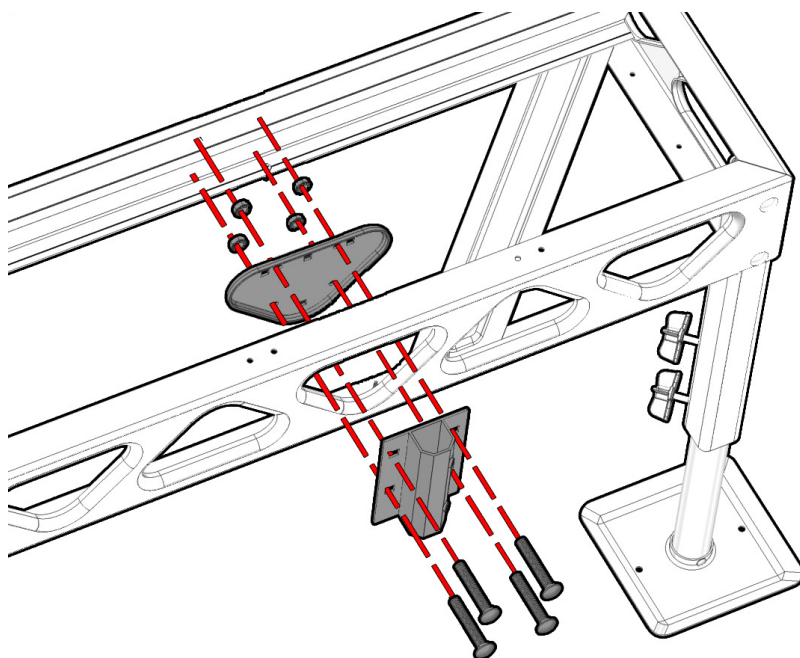

NL38



x4

TPU1



x1

SB1



x1

CB35S



x4

Find an appropriate triangle slot in your dock which will accommodate the flag holder (FH1).
Ensure the slot will not be in the way or interfere with other dock accessories.
Assemble flag pole on dock (As shown above).

PLEASE NOTE: Some components has been removed from the above image to better illustrate how to assemble the flag pole holder.

2

AK1



x2

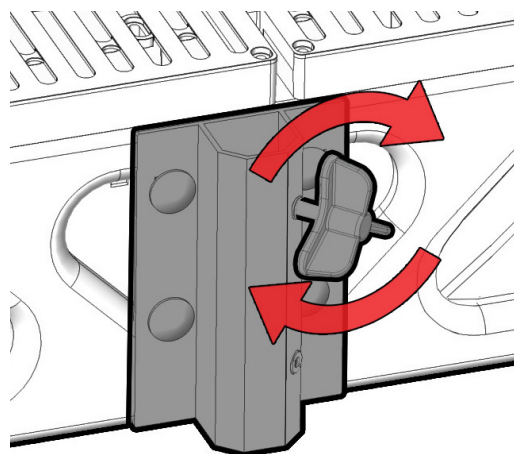
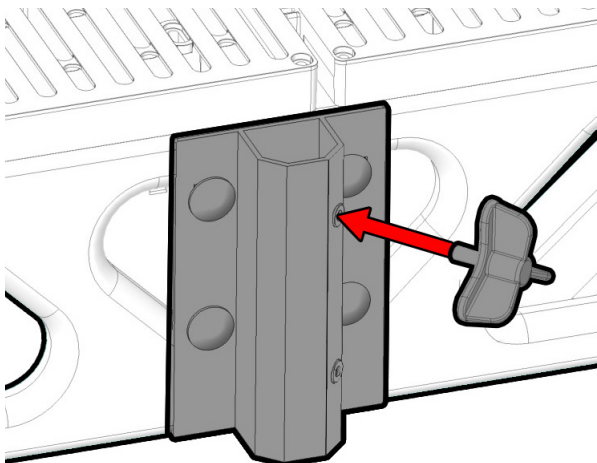

Insert adjustment knob (AK1) and turn handle clockwise to secure to the flag pole holder (See above). Turn the knob only enough times so that it is secure on the flag pole holder. Follow this procedure for bottom knob.

3

FPP01



x1

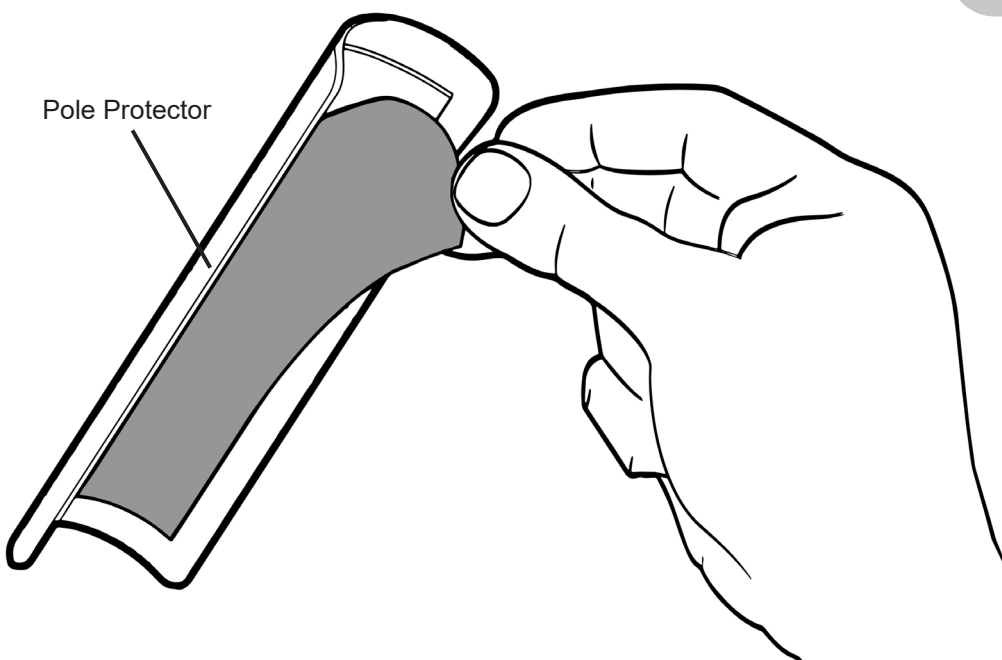

Pull backing off of sticker on the inside of the pole protector.

4

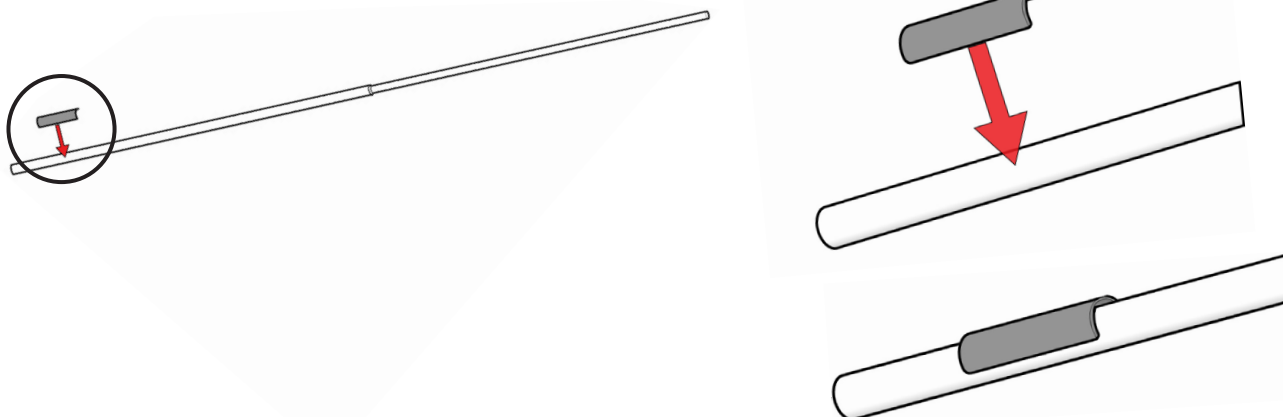

Apply the pole protector onto the flag pole. This component will be used to protect the pole when it is tightened and will need to be positioned near the base of the pole so it will be covered by the mounting bracket.

5

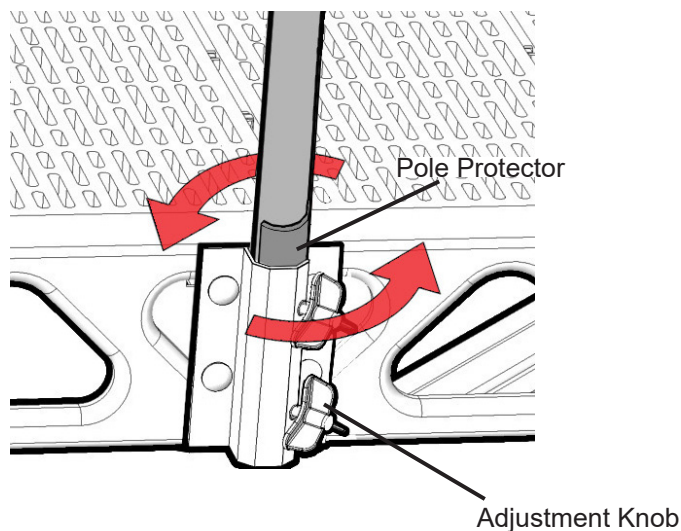
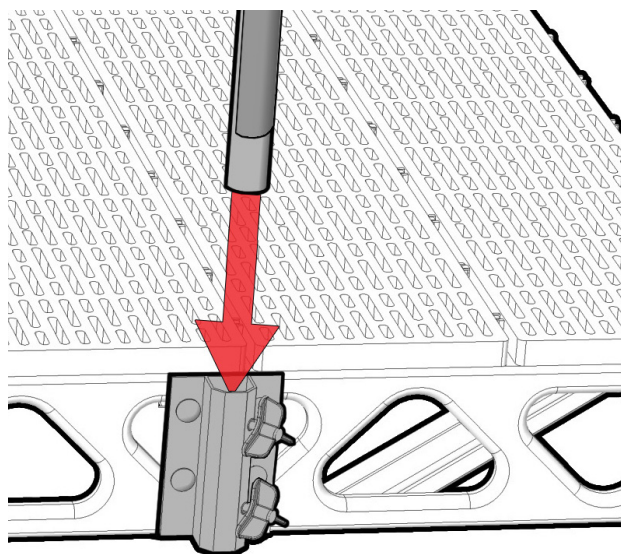

Setup your flag and flag pole according to the manufacturers instructions. Slide and place the base of the flag pole into the open hole at the top of the bracket. Turn and position the flag pole so that the pole protector is directly aligned with the adjustment knobs.

6

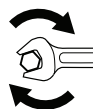
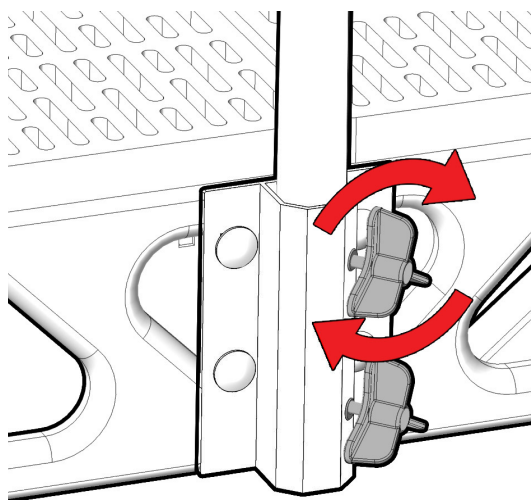
**DO NOT OVERTIGHTEN**

Set the flag pole to your desired height and turn the adjustment knobs clockwise until the flag pole is securely snug inside the flag pole holder. Enjoy your flag!