

## INCLUDED IN KIT:

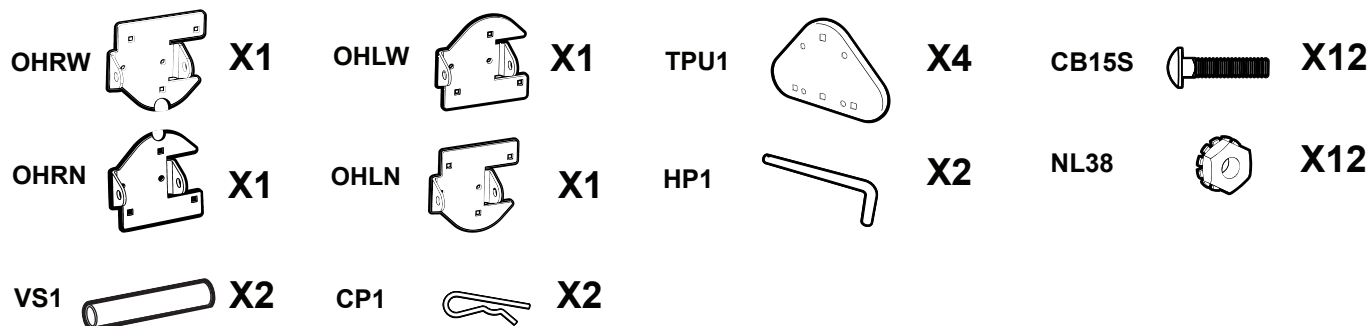

## TOOLS REQUIRED:

9/16" SOCKET WITH RATCHET OR BOX WRENCH TO SUIT

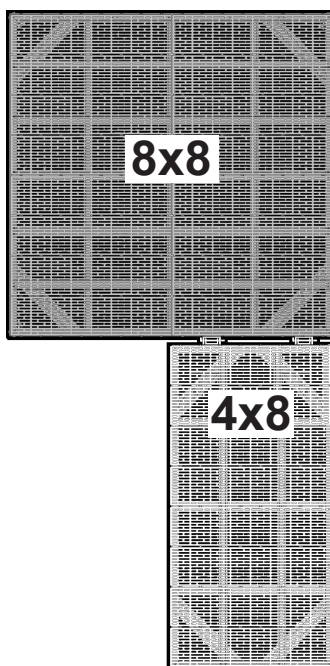
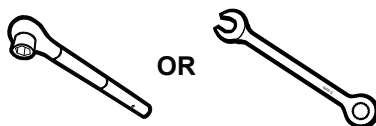

For connecting the 4x8 dock to the **Right side** of the 8x8 dock, follow Steps 1- 4 .

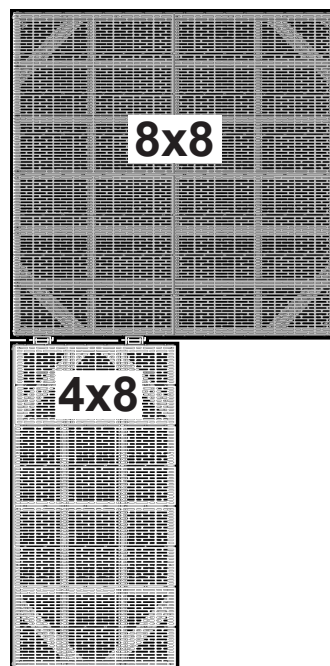

For connecting the 4x8 dock to the **Left side** of the 8x8 dock, follow the Steps 5-8

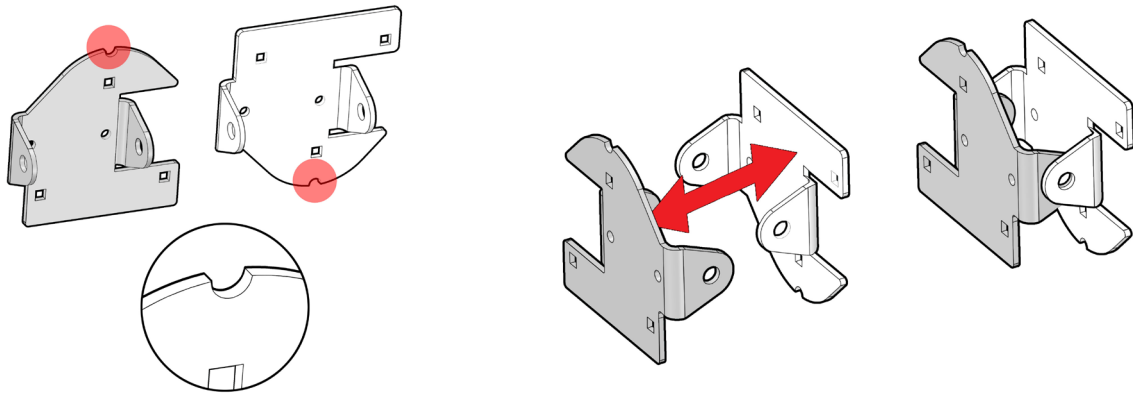

This kit contains four brackets. Two brackets will have a cookie cutter pattern on the top of the bracket. One bracket will have a narrow mouth that will fit into the wider bracket to create a hinge. The two cookie cutter brackets will be paired together to make one hinge.

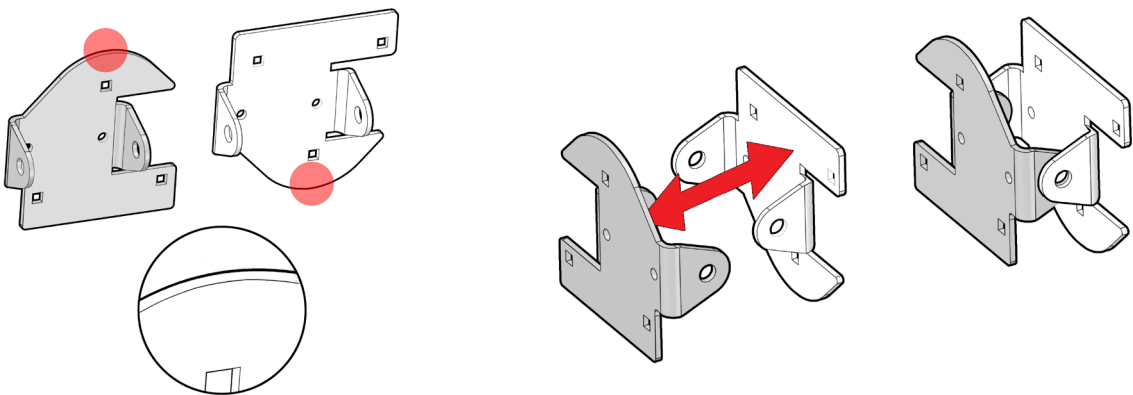

Two brackets will have no cookie cutter pattern on them. One bracket will have a narrow mouth that will fit into the wider bracket to create a hinge. These brackets will be paired together to make one hinge.

Approximately  
5 Inches wide

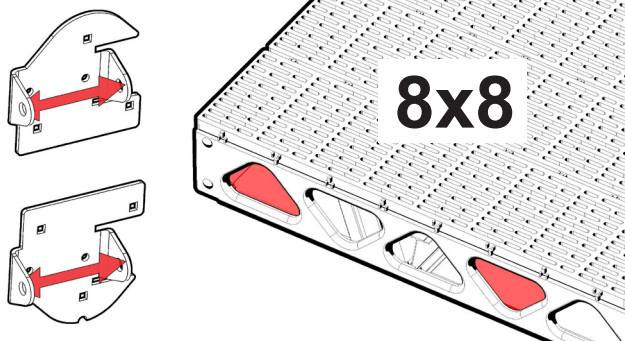

Approximately  
4 Inches wide

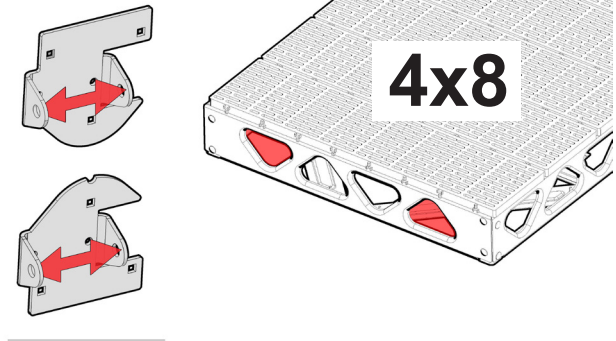

The wide mouth brackets will be installed on the 8x8 docks and the narrow brackets will be installed on the 4x8 docks.

## 1 RIGHT SIDE DOCK PLACEMENT

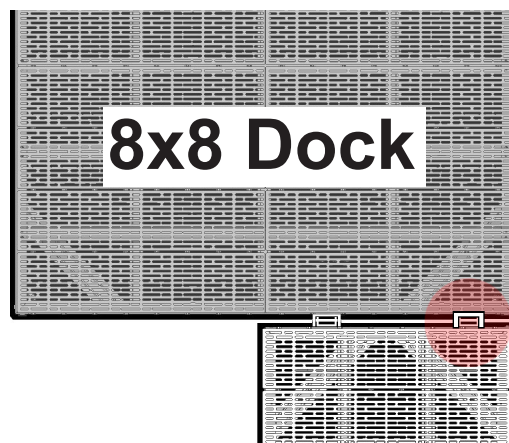
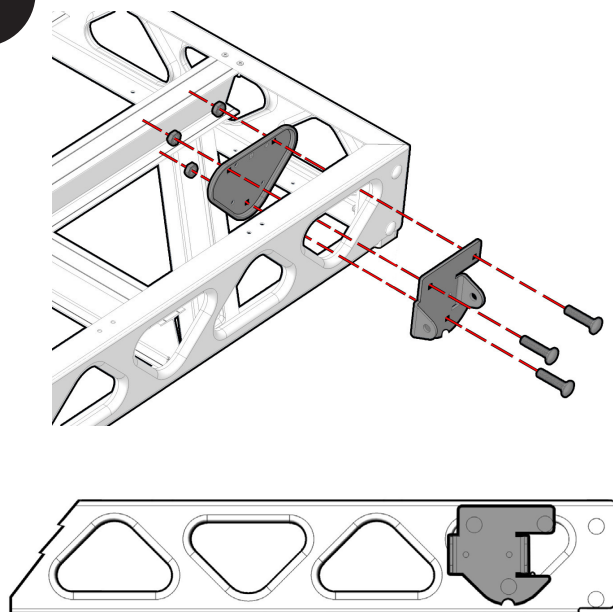

On the 8x8 Dock connect the hinge assembly as shown above.

**PLEASE NOTE:** The decking has been removed from the above the image and some proceeding images to better illustrate assembly.

## 2

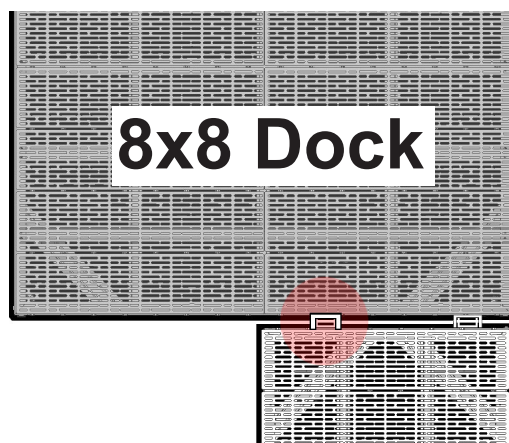
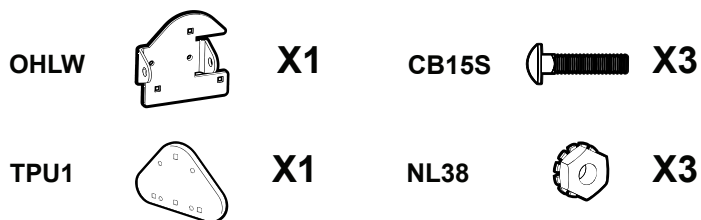
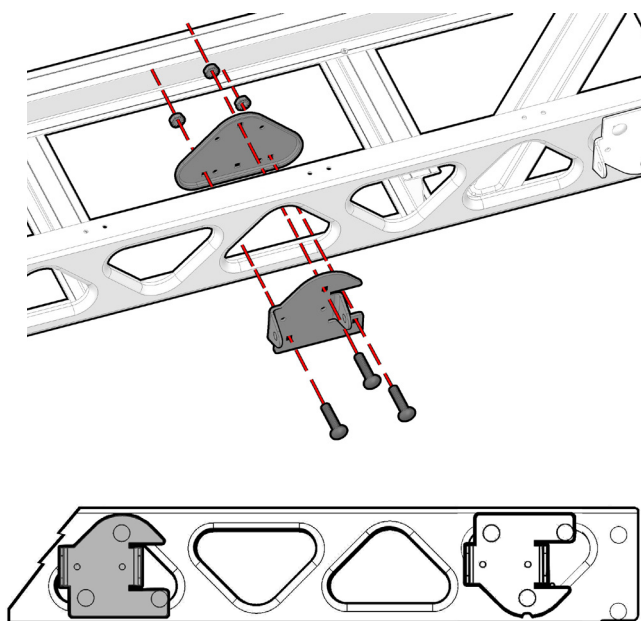

On the 8x8 Dock connect the hinge assembly as shown above.

3

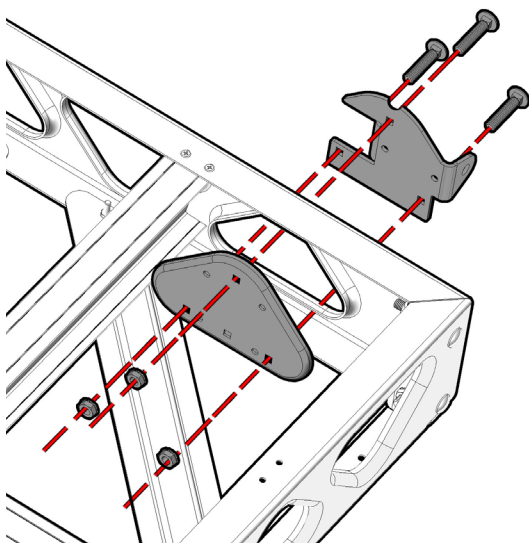

OHRN



X1

CB15S



X3

TPU1



X1

NL38



X3

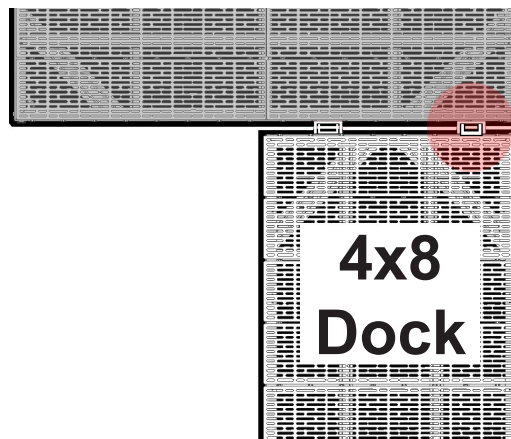

On the 4x8 Dock connect the hinge assembly as shown above.

4

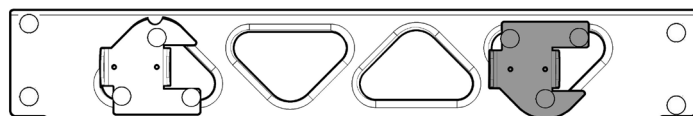
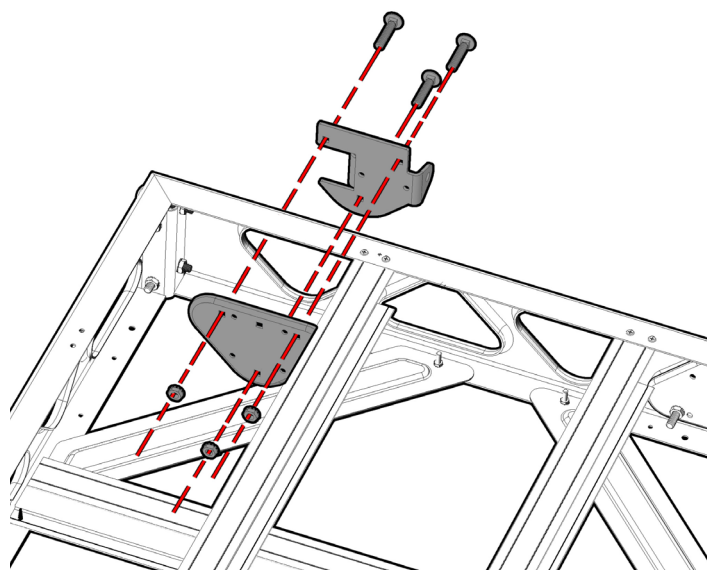

OHLN

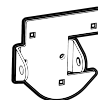

X1

CB15S



X3

TPU1



X1

NL38



X3

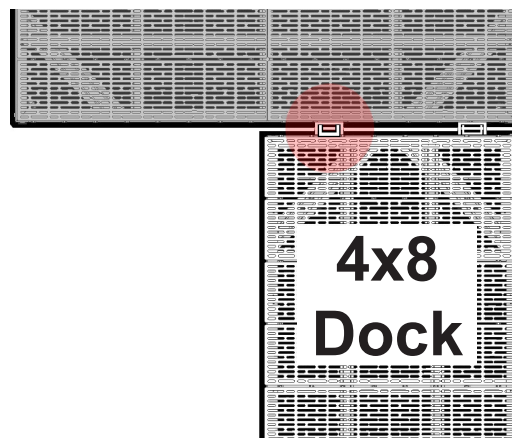

On the 4x8 Dock connect the hinge assembly as shown above.



## 5 LEFT SIDE DOCK PLACEMENT

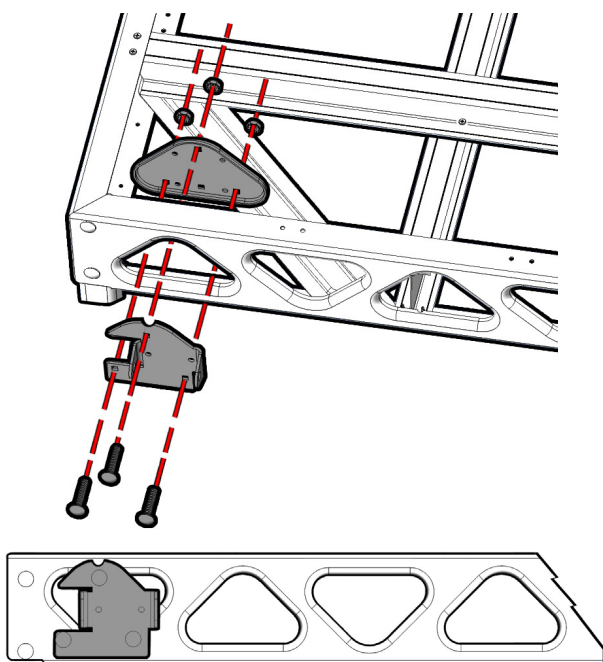

- |      |  |    |       |  |    |
|------|--|----|-------|--|----|
| OHRW |  | X1 | CB15S |  | X3 |
| TPU1 |  | X1 | NL38  |  | X3 |

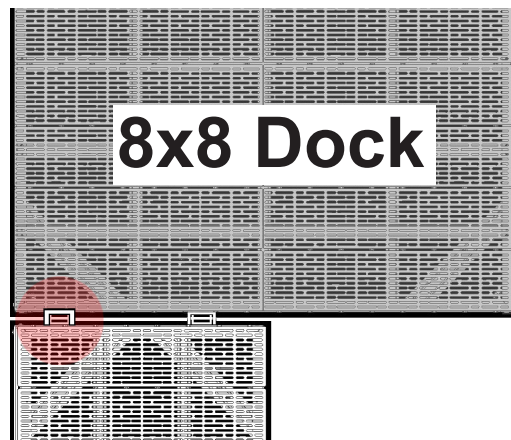

On the 8x8 Dock connect the hinge assembly as shown above.

## 6

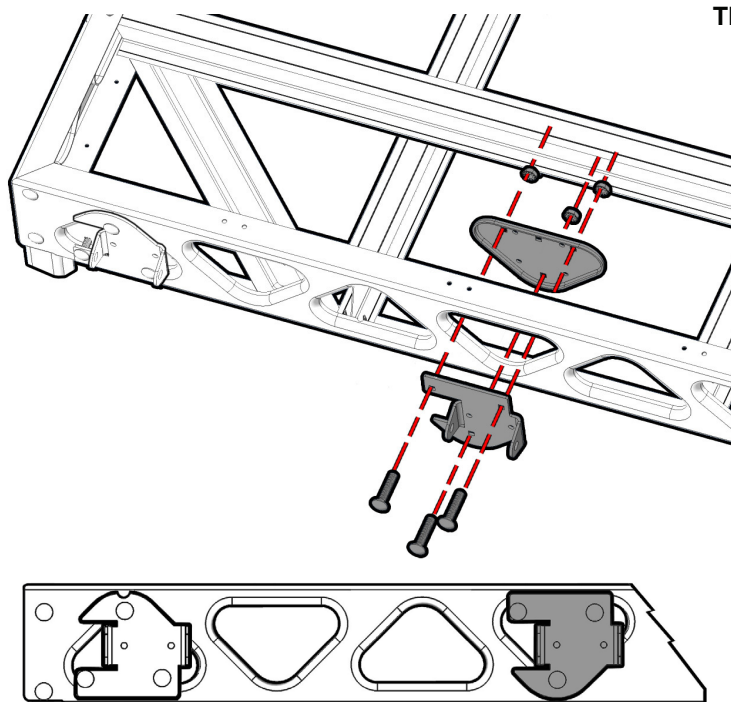

- |      |  |    |       |  |    |
|------|--|----|-------|--|----|
| OHLW |  | X1 | CB15S |  | X3 |
| TPU1 |  | X1 | NL38  |  | X3 |

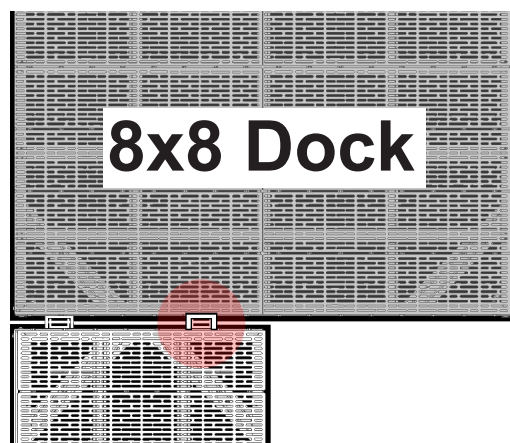

On the 8x8 Dock connect the hinge assembly as shown above.

7

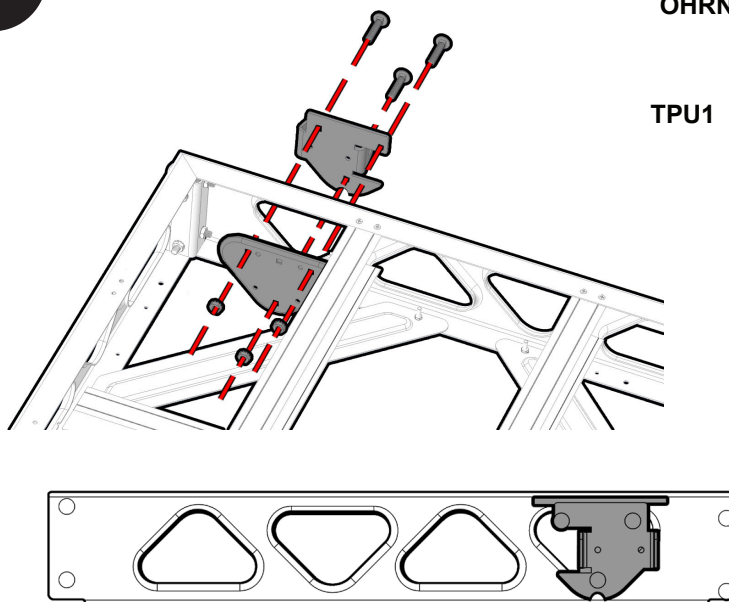

OHRN

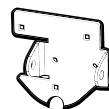

X1

CB15S



X3

TPU1

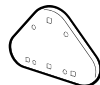

X1

NL38



X3

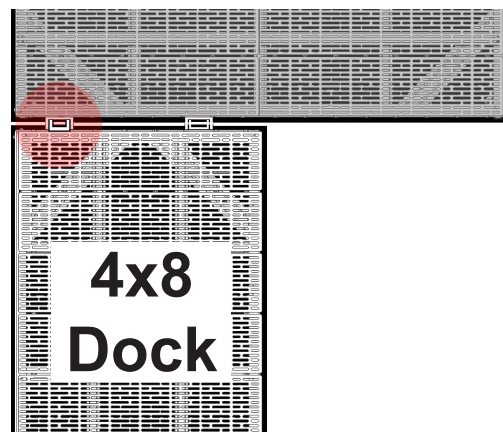

On the 4x8 Dock connect the hinge assembly as shown above.

8

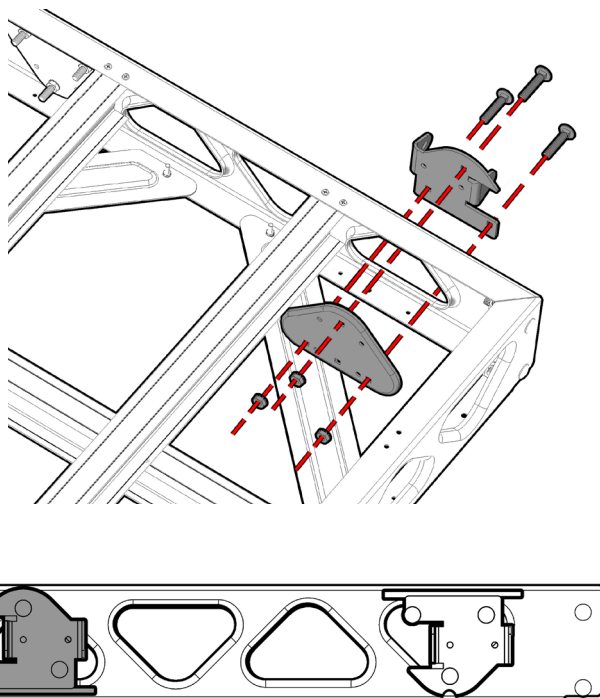

OHLN



X1

CB15S



X3

TPU1



X1

NL38



X3

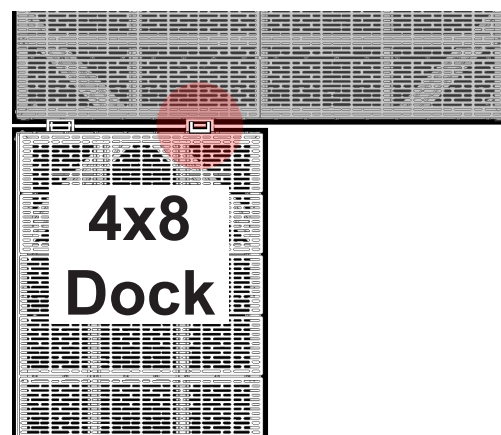

On the 4x8 Dock connect the hinge assembly as shown above.

9

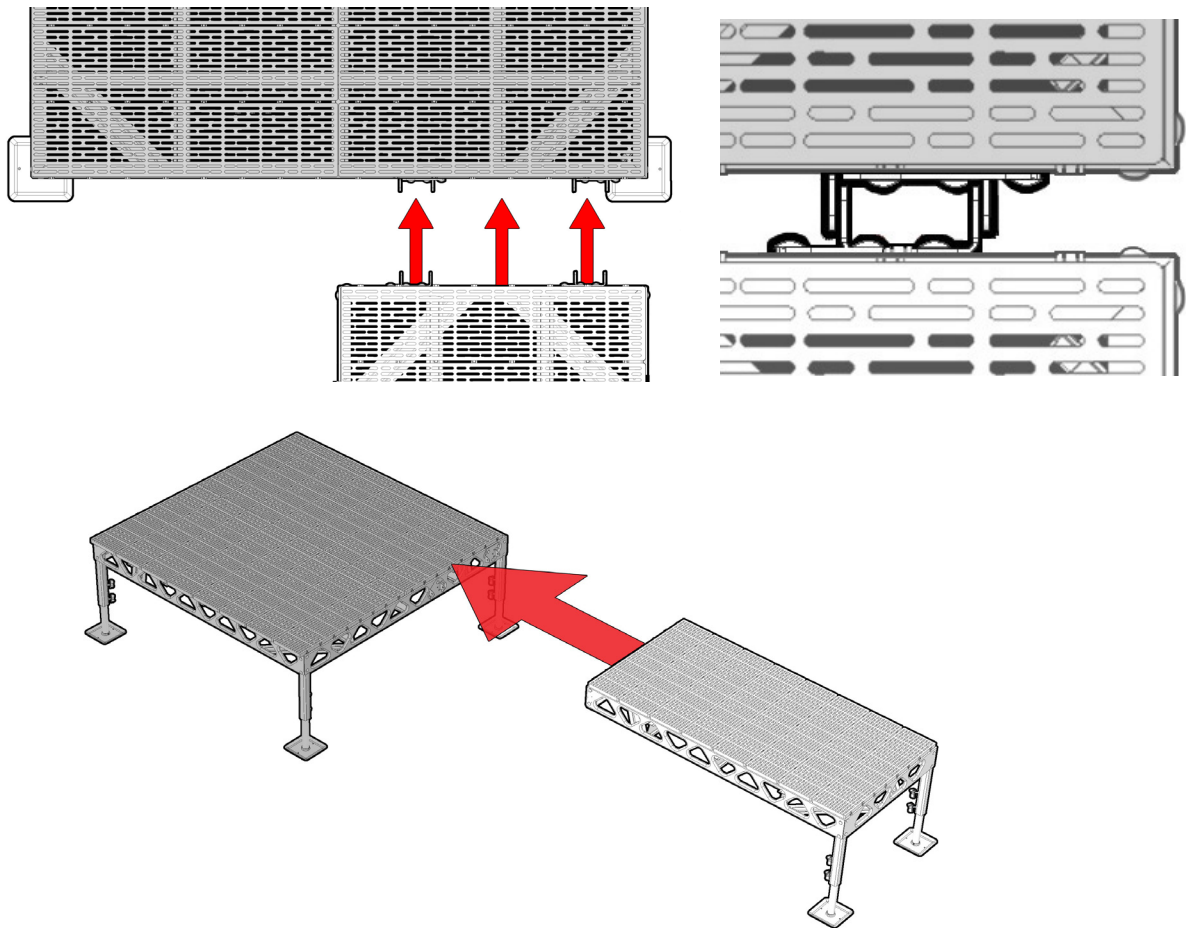

Once the brackets on both docks are assembled pull both docks close to each other. Place the docks so the edges of both docks are aligned with one another. Align the brackets on either side of the docks so they fit into each other (See images above). Ensure that the holes between both brackets line up with one another. Do the same for both hinge assemblies.

10

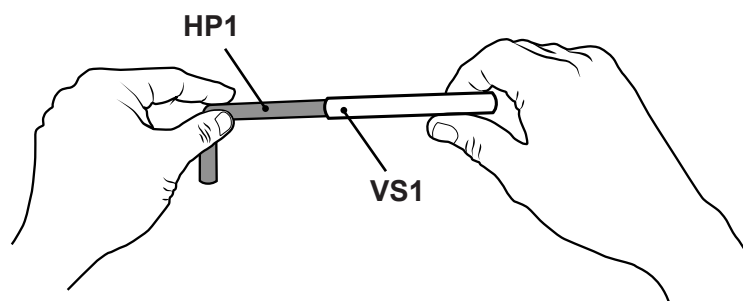

HP1 X2

VS1 X2

An optional sleeve (VS1) has been included with your kit to dampen any movement and sound that may arise from hinge use. Slide the vinyl sleeve onto the end of the pin (HP1).

11

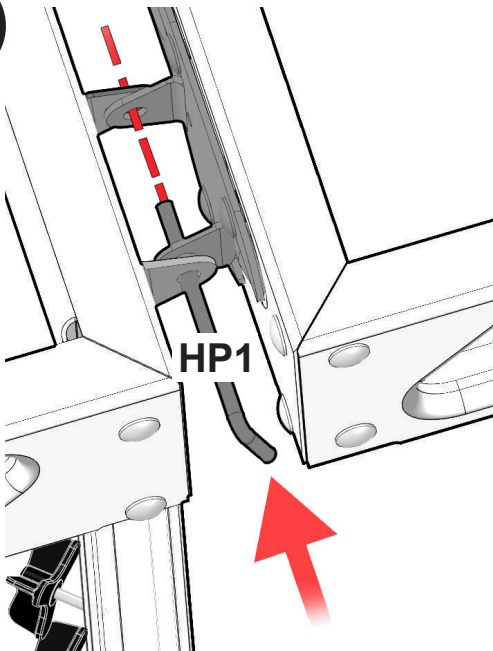

CP1

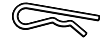

X2

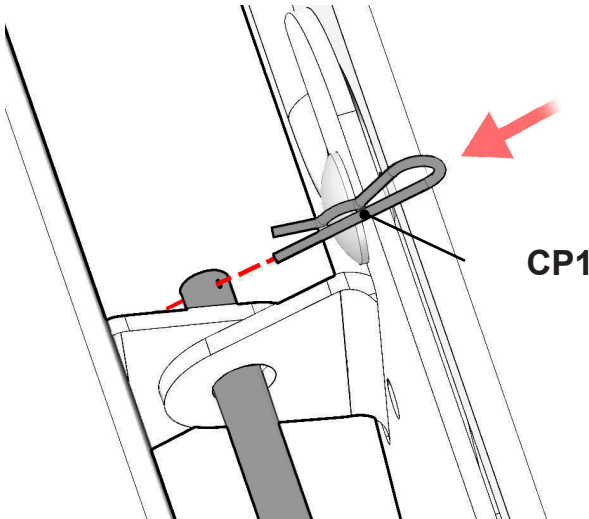
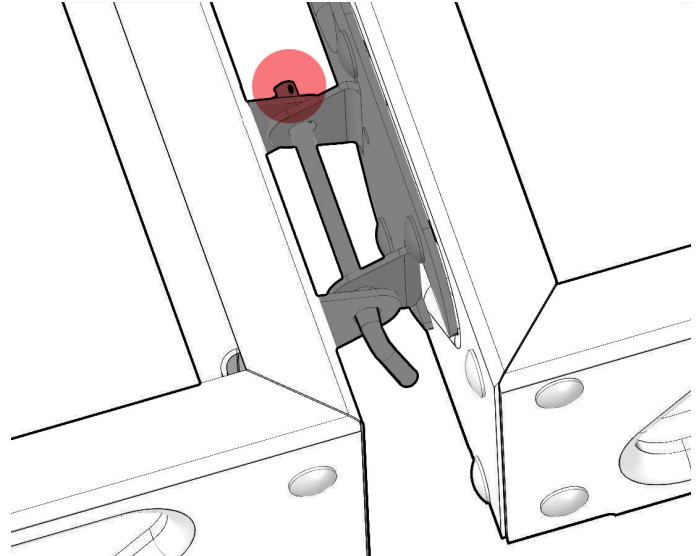

CP1

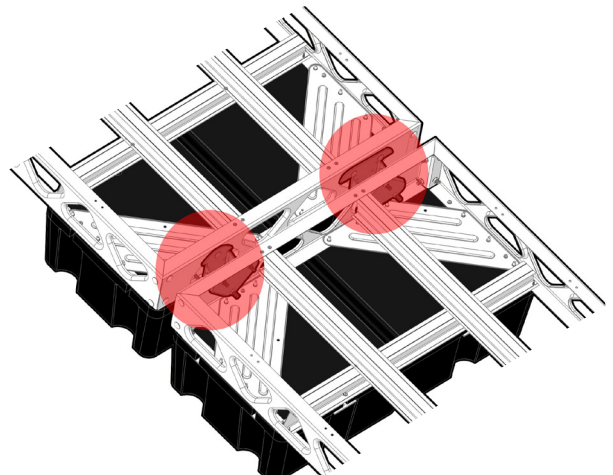

Fasten hinge as shown. Repeat **Step 11** for both hinge assemblies.

**PLEASE NOTE: It may be helpful to use locking pliers to insert the cotter pin into the hinge pin.**

When separating dock sections follow the above directions in reverse removing the Cotter Pin (CP1) and then removing the Hinge Pin(HP1) from between the hinges.