

## TOOLS REQUIRED :

Drill

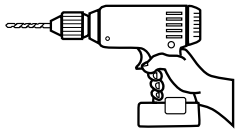

#2 Phillips Drill Bit



1

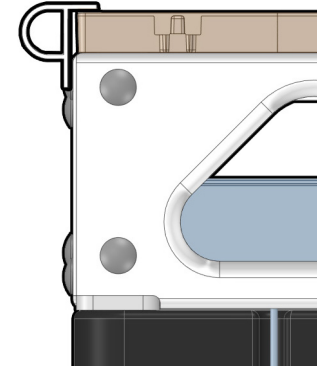
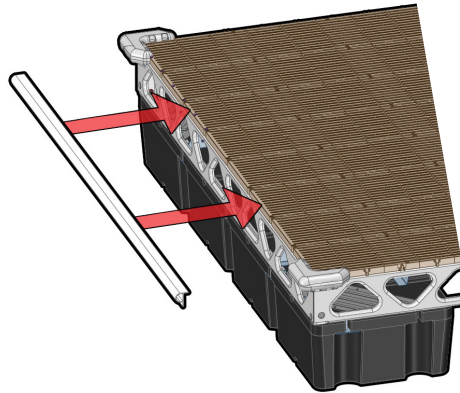

Place the P-Bumper against side of the dock.

2

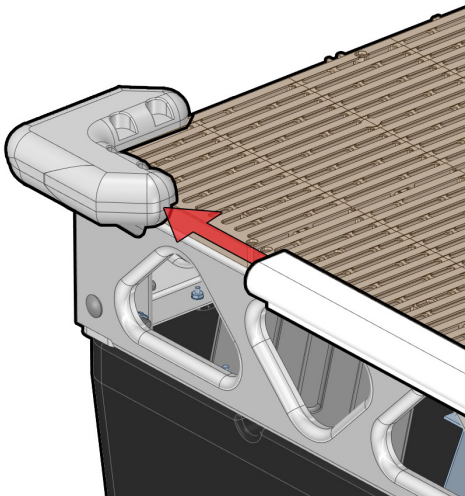

Place and slide the P-Bumper against edge of the Corner Bumper or edge of the dock.

3

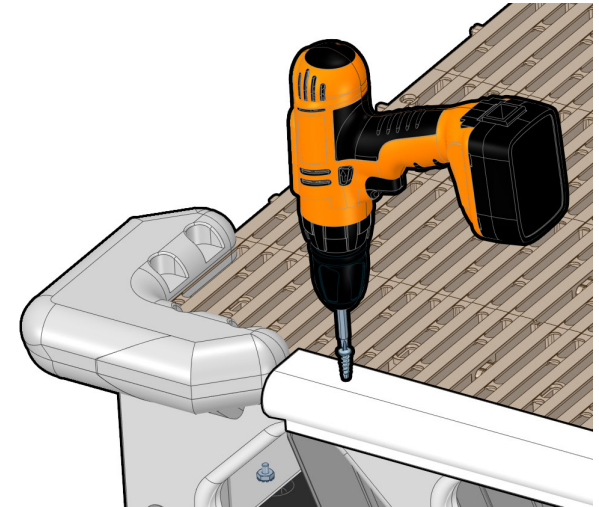
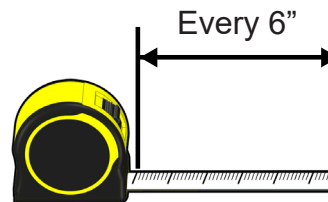
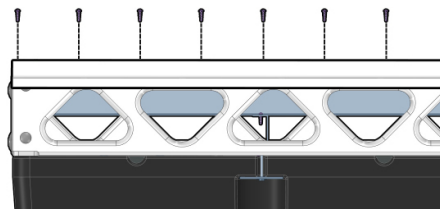

Place and drill your initial screw 1 inch from the end and then every 6 inches into the P-Bumper. Placing a screw approximately an inch near both ends of the P-Bumper will help ensure the bumper does not rip off the dock.

**PLEASE NOTE:** Ensure when fastening the P-Bumper that you place screws over a solid area of decking and not placed over the holes located in the decking.

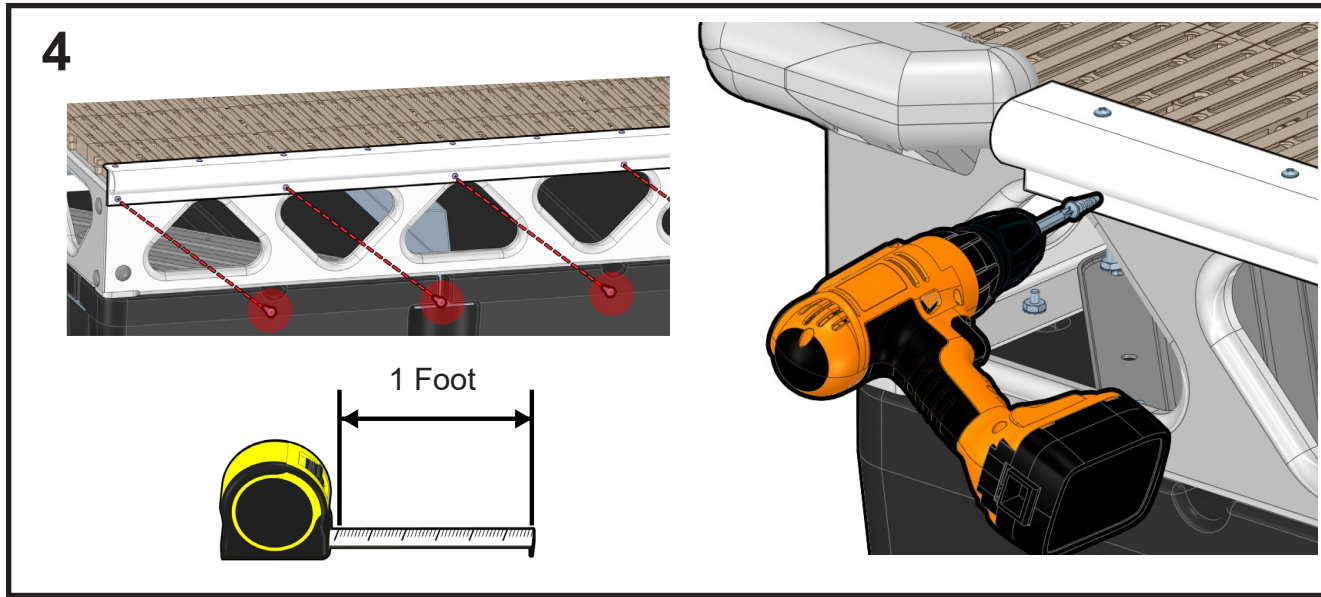

Place and drill your initial screw 1 inch from the end and then every foot along the P-Bumper. Putting a screw approximately an inch near both ends of the P-Bumper will help ensure the bumper does not rip off the dock.

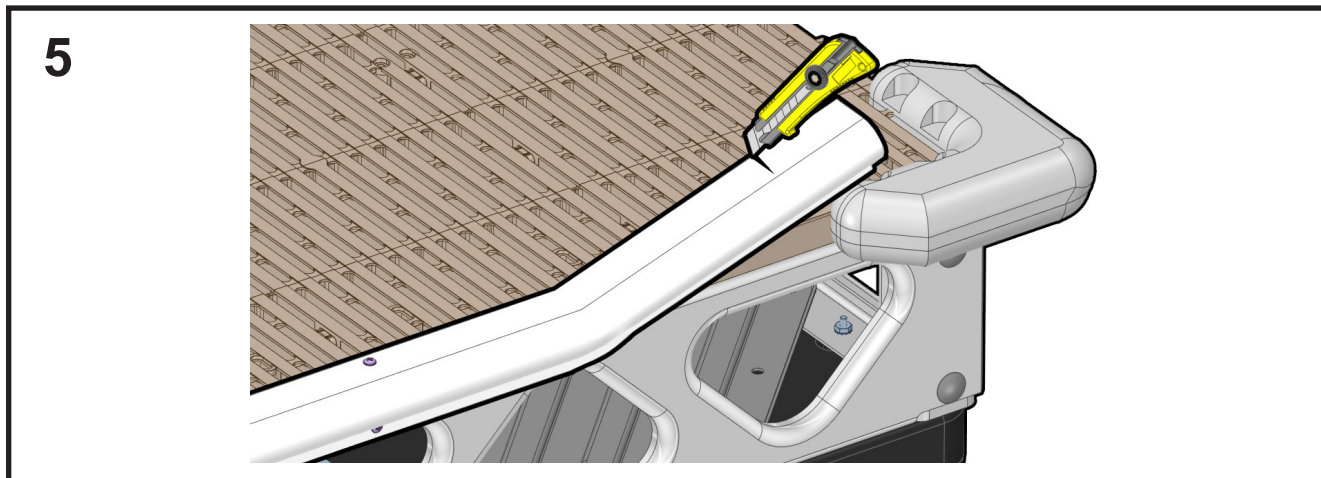

Cut any excess to provide a snug fit against the Corner Bumper or the edge of the dock.  
Repeat steps 1-5 for all additional P-Bumpers added to the dock.