

INCLUDED IN KIT:

KR1



x1

CB35S



x4

NL38



x4

TPU1



x2

SCAP1

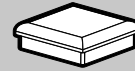

x2

TOOLS REQUIRED:

9/16" SOCKET WITH RATCHET TO SUIT
OR 9/16" BOX WRENCH

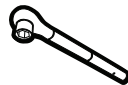

OR



1



KB01



x1

TPU1



x2

CB35S



x4

NL38



x4

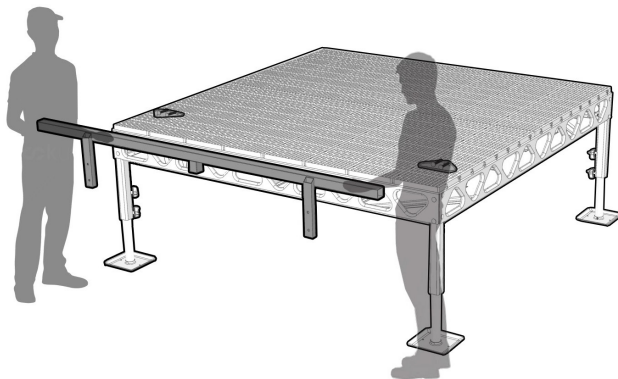

Position the kick rail where it will be installed. It is recommended to use two people for installation.

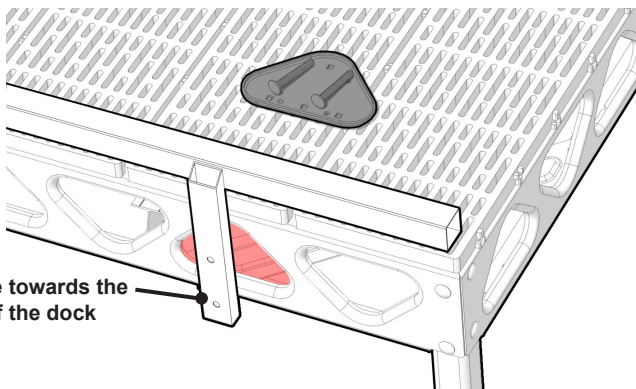

End bars face towards the outside of the dock

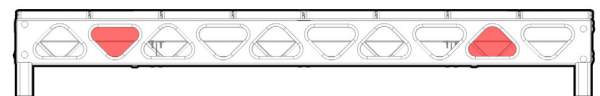

Installation Spacing

Place a triangle plate, two bolts and nuts beside each opening where the kick rail will be attached to the dock.

2

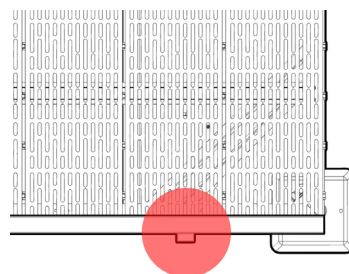
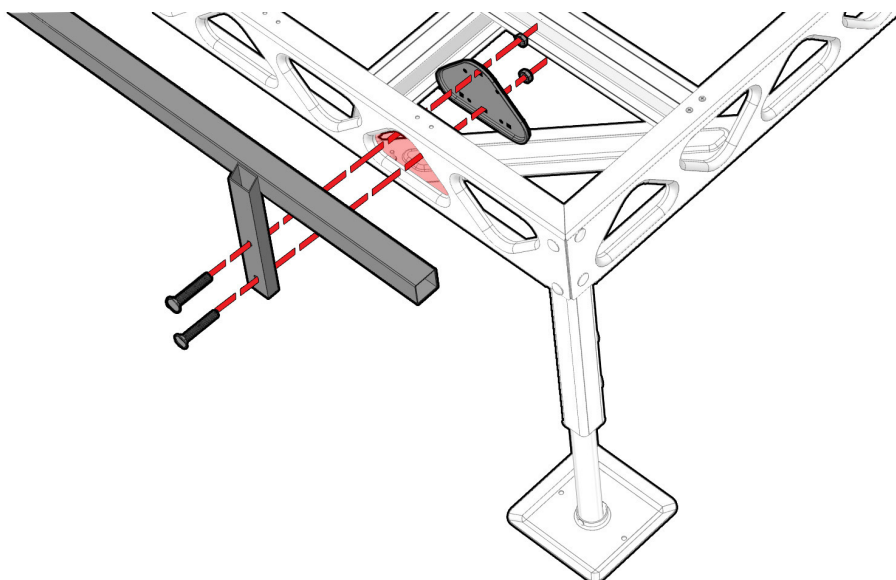

3

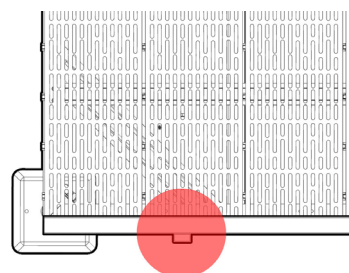
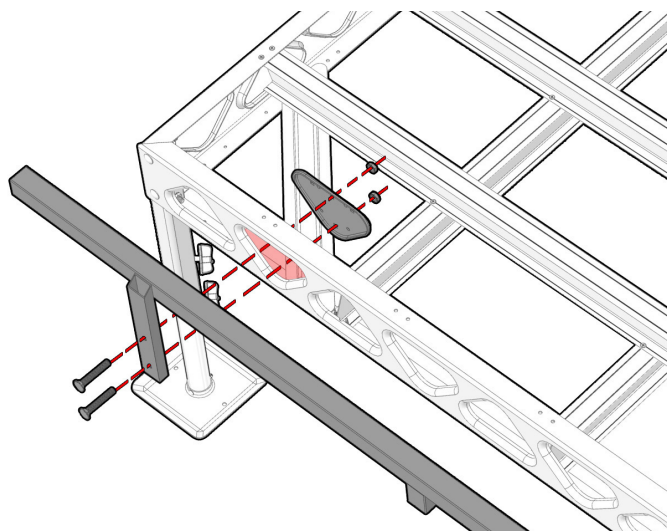

4

SCAP1



X2

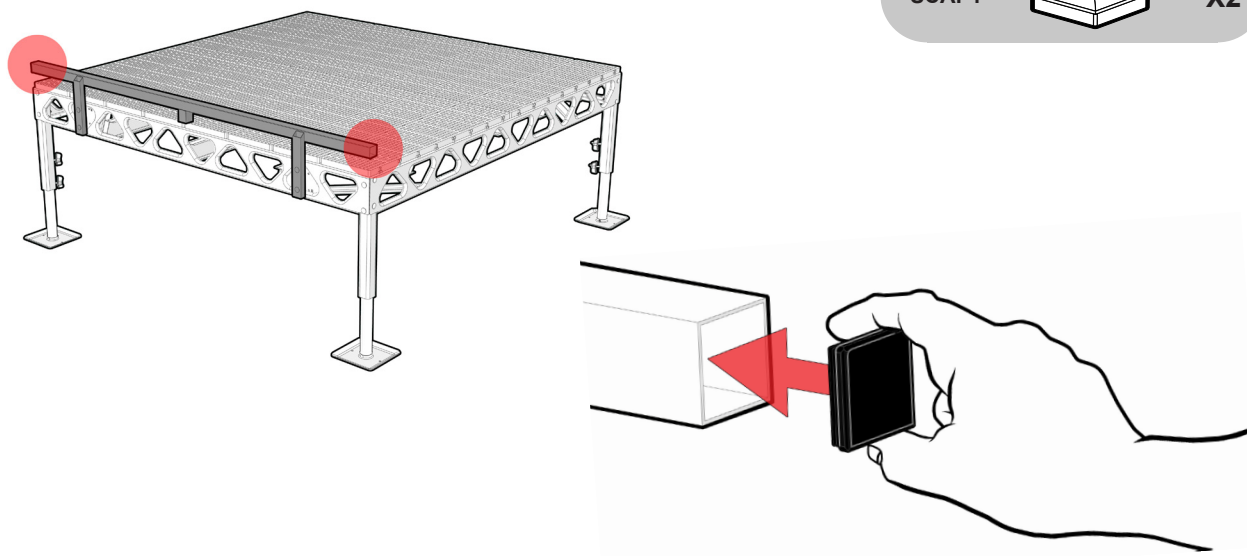

Add caps to each end of the kick rail.

5

